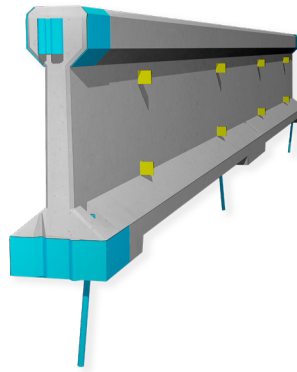

REBLOC 80SA_6_3P

Technical Datasheet

ASI B

REBLOC 80SA_6_3P

**Precast Concrete
Vehicle Restraint System****Temporary System
Anchored****Technical data**

Containment level	N2
Working width	W1 ($W_N \leq 0.6$ m)
Impact severity level	ASI B
Installation	anchored (3 x anchor pins RPIN20_480 in asphalt per element)
Application	single-sided double-sided
Minimum installation length	120 m (20 elements)
Initial/end anchorage	not necessary, optional available
Dimensions L x W x H in cm	600 x 30 x 80 cm
Weight/element	approx. 1520 kg
Curve radius	$r \geq 130$ m, smaller radii on request
Coupling/exposed steel parts	fully integrated, exposed parts hot-dip galvanized
Features	rubber pads in contact areas for protection of the road surface
CE certification	✓

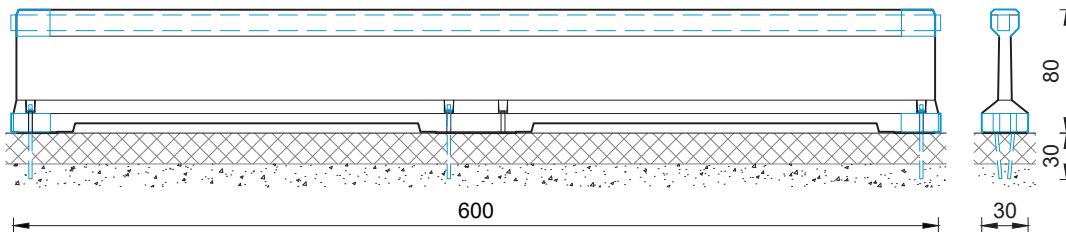

all dimensions in cm